

STRUCTURE IS BUILT ON A -2.5% GRADE

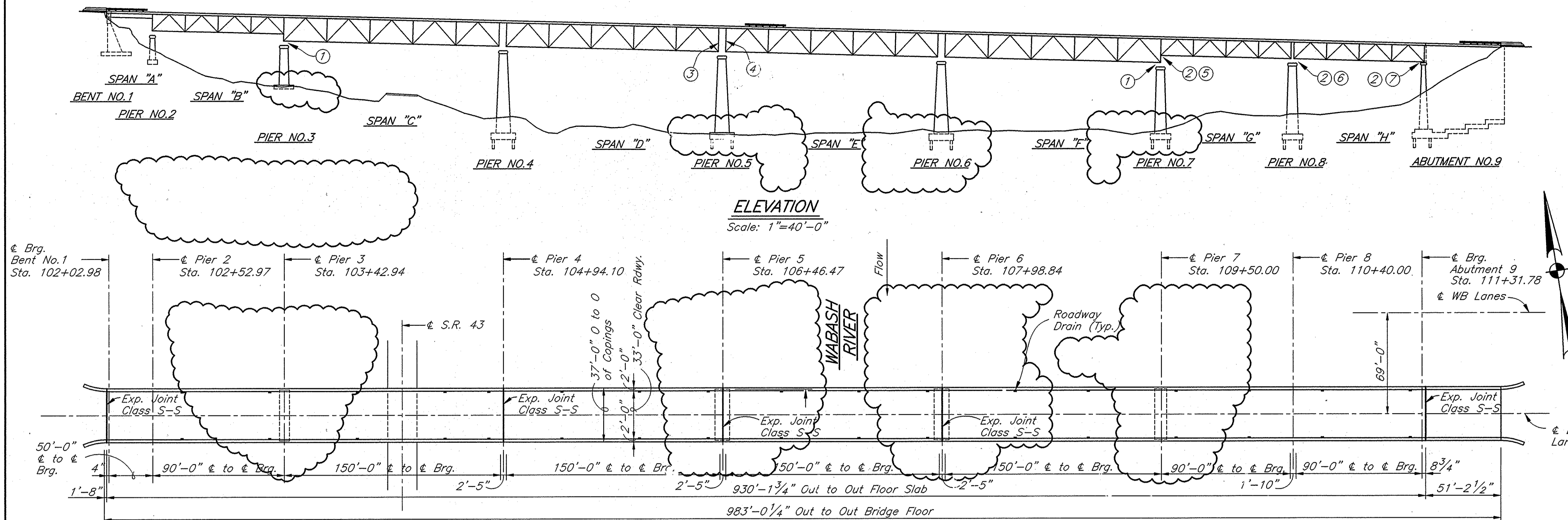

- 1 Add add'l. Gusset Plates at each face of North Truss at Lower Chord Connection. (See Sheet 3, Retrofit 1)
- 2 Add add'l. Gusset Plates at each face of North Truss at Lower Chord Connection. (See Sheet 4, Retrofit 3)
- 3 Install Welded Cover Plate at North Flange of Vertical End Post on North Truss (See Sheet 3, Retrofit 2)
- 4 Install Welded Cover Plate at South Flange of Vertical End Post on South Truss (See Sheet 3, Retrofit 2)
- 5 Add add'l. Gusset Plates at North Face of South Truss at Lower Chord Connection. Drill Crack Arrest Hole in Gusset Plate at North Face of South Truss of Lower Chord. (See Sheet 4, Retrofit 3)
- 6 Add add'l. Gusset Plates at South Face of South Truss at Lower Chord Connection. (See Sheet 4, Retrofit 3)
- 7 Add add'l. Gusset Plates at each face of South Truss at Lower Chord Connection. (See Sheet 4, Retrofit 3)

Note: Plates shall be added one Plate at a time. Work started which affects the Structural Capacity of the Truss shall be completed the same day.

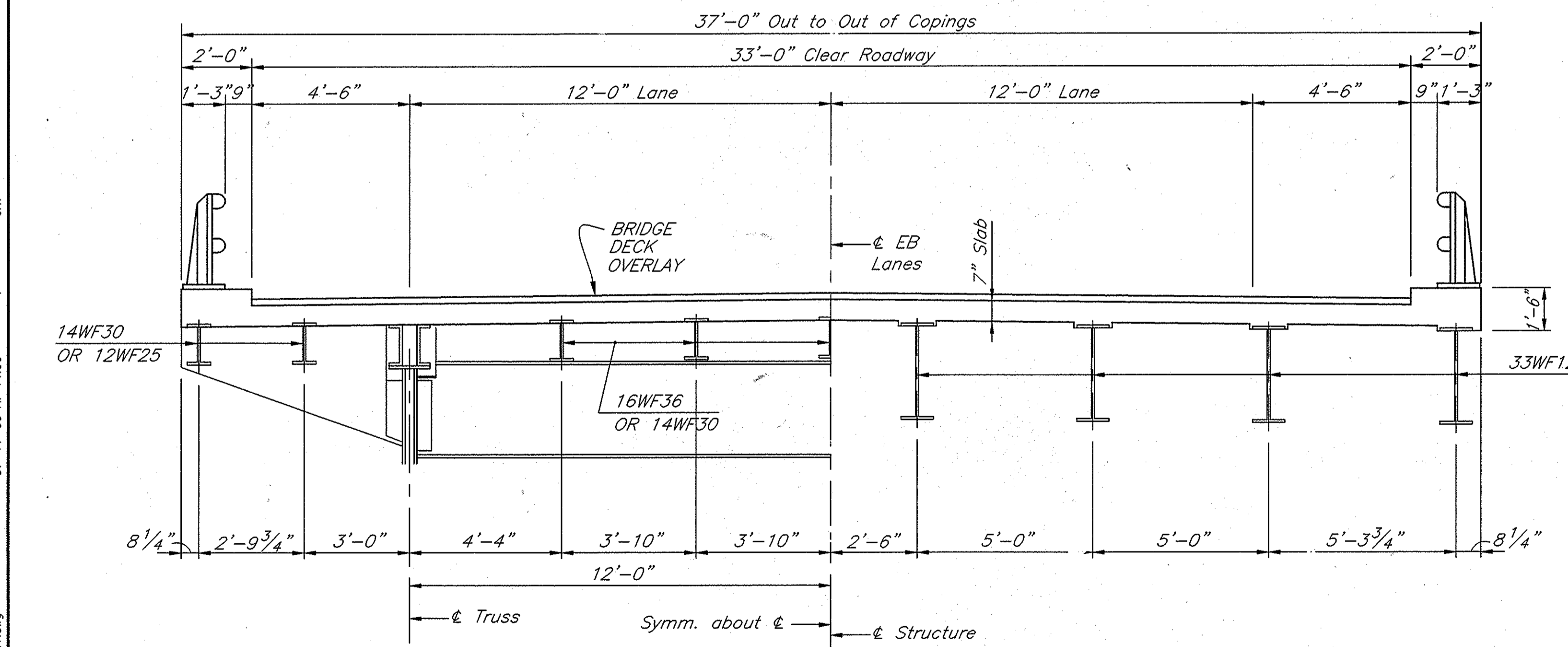
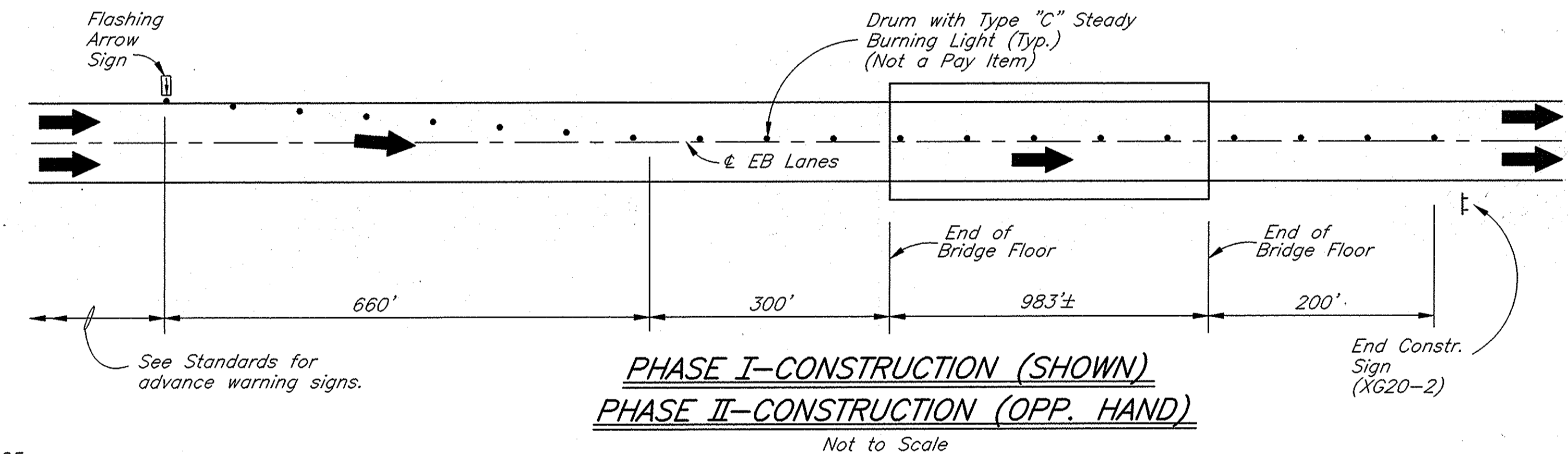

GENERAL NOTES

Plans for Existing Structure are on file in the Bridge Department at the Indiana Department of Transportation, Central Office, as Bridge File 52-79-1784 and are available upon request.

Where new work is to be fitted to old work, the Contractor shall check all dimensions and conditions in the field and report any errors or discrepancies to the Engineer and assume responsibility for their correctness and the fit of the new part to old.

All structural steel repairs shall be shop primed and field painted once repair is complete.

All Paint shall be in accordance with the current Indiana Department of Transportation Specifications except the color of the Vinyl Finish Coat shall be the same color as the existing paint.

STEEL TRUSS BRIDGE
 8 SPANS: 1@50'-0", 1@90'-0", 4@150'-0" AND 2@90'-0", NO SKEW, 33'-0"
 CLEAR ROADWAY ON U.S. 52 BY-PASS OVER WABASH RIVER AND S.R. 43.

NOTES
 Traffic Maintenance required for Daylight Lane Closure Only.
 All Lanes of Traffic to be Open after Daylight Working Hours.

07-11-06 AT 1406
07-11-06 AT 1406
07-11-06 AT 1406

 8450 WESTFIELD BLVD., SUITE 300 INDIANAPOLIS, IN 46240 317 713-4615 FAX 317 713-4616 509 WEST 84TH DRIVE, SUITE G MERRILLVILLE, IN 46410 219 789-2333 FAX 219 789-2377	RECOMMENDED FOR APPROVAL: <i>Michael D. Eichenauer</i> 4-7-05 DESIGN ENGINEER DATE	INDIANA DEPARTMENT OF TRANSPORTATION GENERAL PLAN	HORIZONTAL SCALE AS NOTED BRIDGE FILE 52-79-1784EEBL
	DESIGNED: M. EICHENAUER DRAWN: D. SHEETZ CHECKED: J. SERA CHECKED: M. EICHENAUER		VERTICAL SCALE AS NOTED DESIGNATION 0400067 SHEET 2 OF 4 CONTRACT B-28152 PROJECT STP-4979(008)

7/11/06: Remove Riprap Scour Protection from Piers No. 3, 5, 6 & 7

Note:
 $\frac{15}{16}$ " Holes shown for $\frac{7}{8}$ " Bolts (A490) to replace exist. Rivets.

⊕ Grind in Field if req'd. for Fit.

* See Note ① on Sheet 2 for Plate Locations.

⊕ Verify in Field

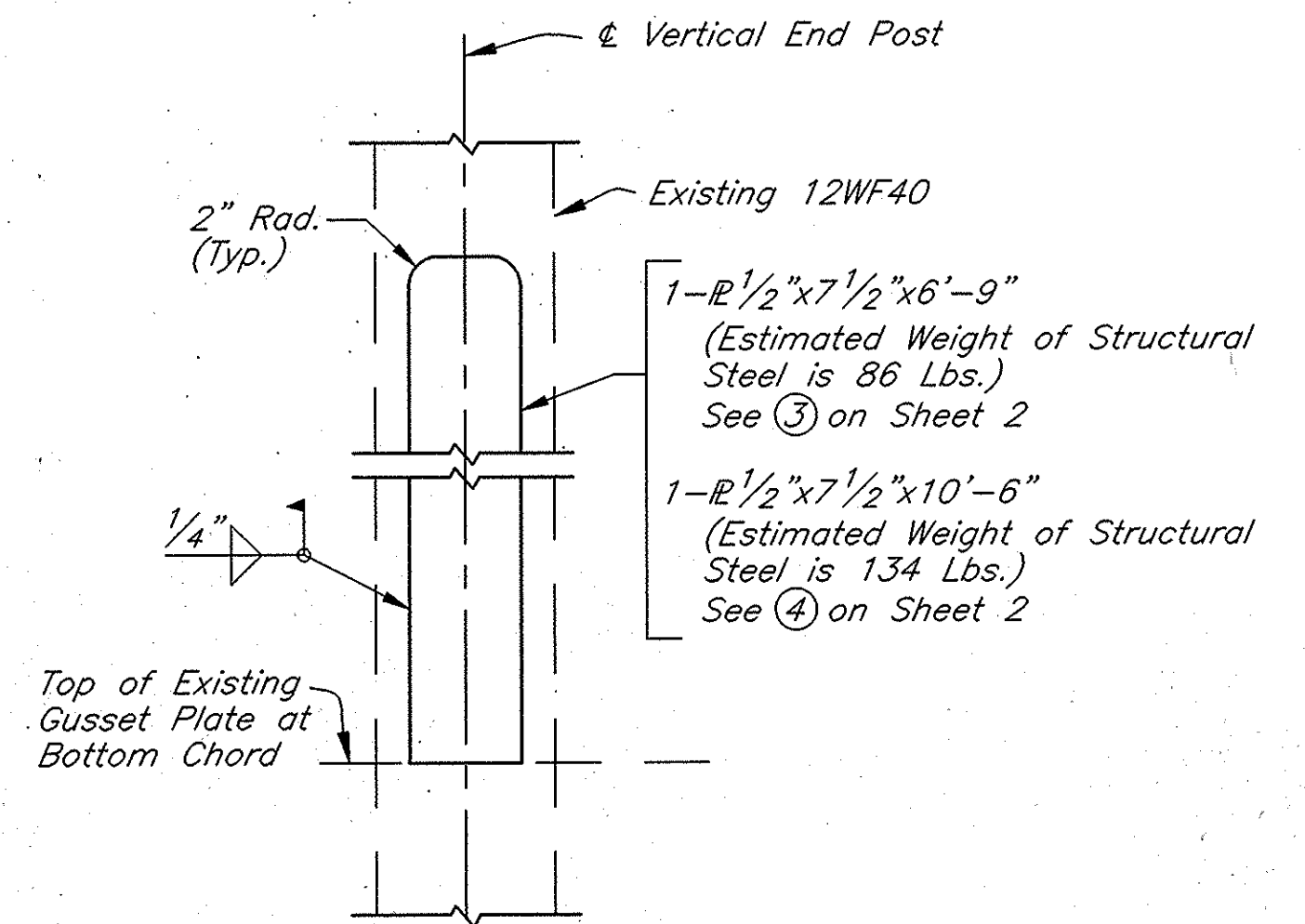

ELEVATION OF VERTICAL END POST
 AT PIER NO.5

RETROFIT NO.2

Scale: 1"=1'-0"

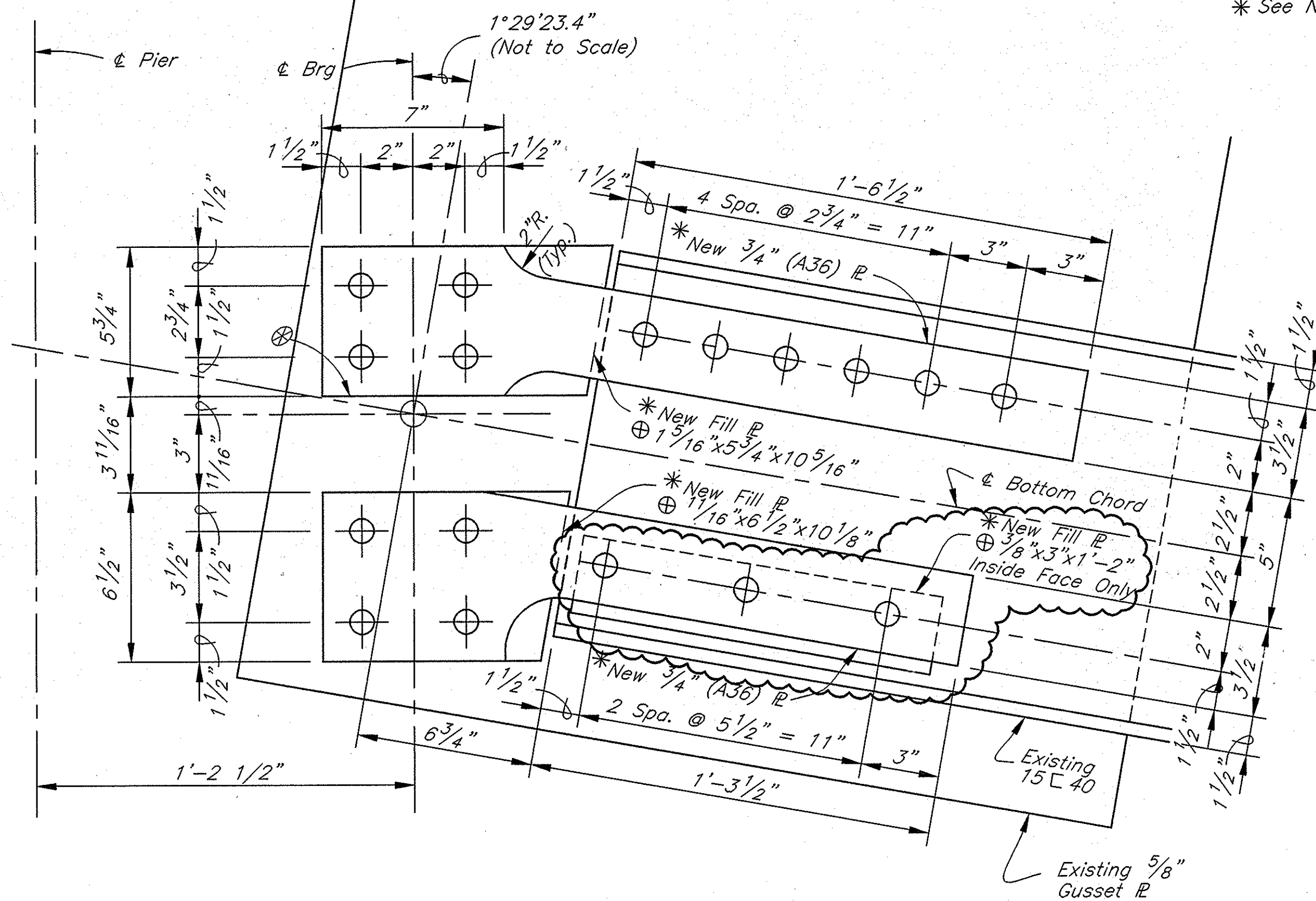

ELEVATION OF NORTH TRUSS BOTTOM CHORD
 SPAN "C" AT PIER NO.3

(Estimated Weight of Structural Steel Outside Face is 108 Lbs.)
 (Estimated Weight of Structural Steel Inside Face is 113 Lbs.)

RETROFIT NO.1

Scale: 3"=1'-0"

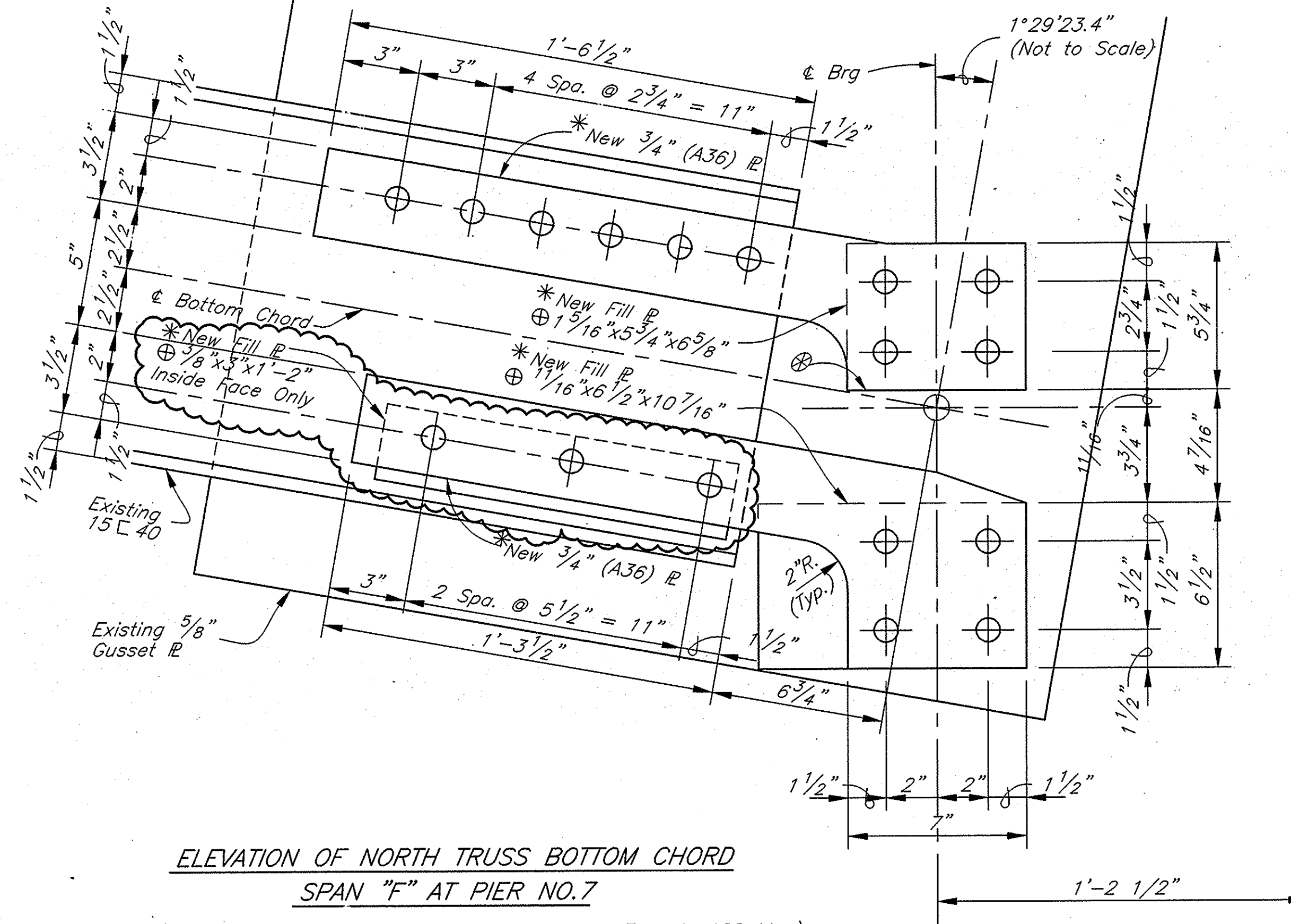

ELEVATION OF NORTH TRUSS BOTTOM CHORD
 SPAN "F" AT PIER NO.7

(Estimated Weight of Structural Steel Outside Face is 100 Lbs.)
 (Estimated Weight of Structural Steel Inside Face is 105 Lbs.)

NOTES

The New Steel Plates shown are to be added to the outside Steel Surfaces of the Existing Gusset Plates, Lower Channels or Clip Angles.
 Filler Plates shall be installed as required to provide smooth, continuous, contact surface between the New and Existing Steel Surfaces.
 Field Reaming will be allowed.
 No Charpy tests will be required.

07-11-06 AT 14.03

R:\4208.02\08\14702401\BRIDGE\120808222.dwg

7/11/06: Added Fill Plates

BFS
 Buder Fairman Seufert
 CIVIL ENGINEERS
 8450 WESTFIELD BLVD., SUITE 300
 INDIANAPOLIS, IN 46240
 317 713-4615
 FAX 317 713-4616

REGISTERED
 No. 19900474
 STATE OF INDIANA
 PROFESSIONAL ENGINEER

RECOMMENDED FOR APPROVAL: *Michael W. Eichenauer* 4-7-05
 DESIGN ENGINEER DATE
 DESIGNED: M. EICHENAUER DRAWN: D. SHEETZ
 CHECKED: J. SERA CHECKED: M. EICHENAUER

INDIANA
 DEPARTMENT OF TRANSPORTATION
 MISCELLANEOUS DETAILS

HORIZONTAL SCALE	BRIDGE FILE
AS NOTED	52-79-1784EEBL
VERTICAL SCALE	DESIGNATION
AS NOTED	0400067
SURVEY BOOK	SHEET
	3 OF 4
CONTRACT	PROJECT
B-28152	STP-4979(008)

BFS No. 4208.0208

